

Lifters, standard coupling Starcon

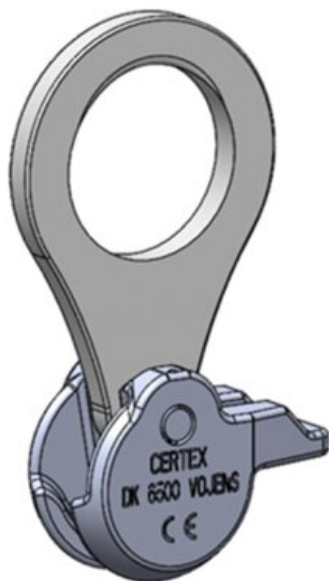

Product information

The Starcon Lifting Eye is a special steel component made for concrete casting. The spherical claw grips on to the head below the Starcon head anchor. The Starcon lifting eye has been tensile tested with 2 times of the safe load. Unique certificates are made for each delivery.

The Starcon product is designed according to EN13155-2009 and follows the guidelines in VDI/BV-BS 6205 and DS/CEN/TR 15728.

Material: Steel

Marking: CE-marked, UKCA-marked, Batch code, Load group, WLL, Starcon

Finish: Electro galvanized

Safety factor: 4:1

Note: The delivery time for the individual products is estimated and if the desired quantity is not in stock, please contact [CERTEX Danmark A/S – Starcon](#) for information on the applicable delivery time.

Part Code	Load grp.	d mm	L mm	Ø mm	Weight kg	Delivery time
650220013001	1-1.3	34	130	42	0.61	100
650220025001	1.5-2.5	42	165	60	1.12	100
650220050001	3-5.0	55	200	62	2.39	100
650220100001	6-10.0	74	285	100	5.6	100
650220200001	12-20.0	110	370	120	13.38	2

Blueprint

